



NH COLLECTION

GRAND HOTEL KRASNAPOLSKY

Location

The hotel is located in the heart of Amsterdam's characteristic historical centre with a view of the Royal Palace. Trendsetting shopping streets are around the corner, as well as museums like Anne Frank House and the Rijksmuseum. Amsterdam Central Station is at seven minutes walking distance, and bus and tram stops are just around the corner.

Station Amsterdam Central **0,7 km**

Airport Schiphol **15 km**

Bus stop **0,1 km**



Contact

Dam 9, 1012 JS, Amsterdam

The Netherlands

Information: +31 (0)20 554 9111

Reservations: +31 (0)20 70 18 042

nhcollectionkrasnapsky@nh-hotels.com

Contact for Meetings & Events

nhmeetingsales.nl@nh-hotels.com

+31 (0)85 902 23 00

nh-collection.com



own parking



free wi-fi



accessible



celebrations



meetings



pets allowed



451 Rooms

- 17 Superior Individual Rooms
- 124 Superior Rooms
- 6 Superior Rooms with view
- 194 Premium Rooms
- 6 Premium Rooms XL
- 16 Premium Rooms with view
- 6 Premium Rooms XL with view
- 9 Premium Rooms with view & terrace
- 10 Premium Triple Rooms
- 8 Family Rooms
- 6 Suites
- 12 Suites with view
- 1 Royal Suite
- 1 Presidential Suite
- 35 Apartments

Hotel facilities

- Dry cleaning service
- Ironing and laundry service
- Indoor parking (paid)
- Valet parking (daytime)
- Free newspaper
- Fitness
- Bicycle rental
- Facilities for the disabled
- Concierge services

Room facilities

- Recently renovated rooms
- Mattresses exclusively designed for NH Collection
- Choice of pillows
- Individually-controlled air conditioning
- 24/7 in-room dining
- Free wireless internet access
- Nespresso coffee machines
- Mini bar
- Exclusive amenity line
- Professional hairdryer
- International power adapters

Food & drinks

- Grand Café Krasnapolsky
- Sumptuous breakfast buffet in iconic monumental Winter Garden
- Bar The Tailor
- 'Early bird' breakfast
- Restaurant The White Room by Jacob Jan Boerma

Meetings & events

- 17 meeting rooms
- Capacity for up to 2,000 people
- Monumental Winter Garden
- State of the art AV facilities
- Special banqueting menu by 3* Michelin chef Jacob Jan Boerma



NH COLLECTION

GRAND HOTEL KRASNAPOLSKY

Function rooms and their capacities

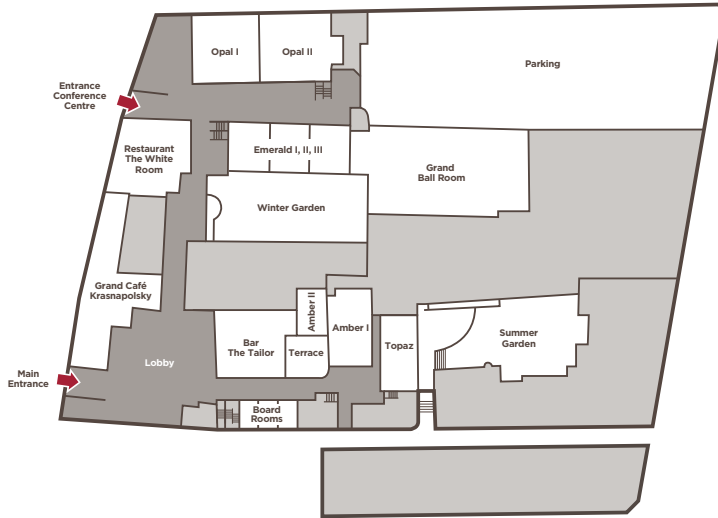

GROUND FLOOR

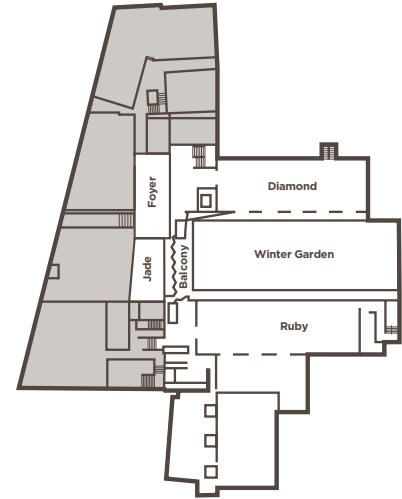

FIRST FLOOR

MEETING ROOM NAME	AREA		square	u-shape	theatre	cabaret	classroom	cocktail	dinner	DAYLIGHT	
	M ²	FEET									
Grand Ballroom	510	5490	50	90	700	265	346	600	320	-	
The Winter Garden	462	4973	-	-	-	-	-	600	320	Yes	
The Winter Garden + Emerald Rooms	677	7288	-	-	-	-	-	750	490	Yes	
The Winter Garden + Grand Ballroom + Emerald Rooms	1187	12778	-	-	-	-	-	1500	840	Yes	
Opal I	131	1475	20	30	160	48	60	100	80	Yes	
Opal II	181	2035	30	42	240	80	110	150	120	Yes	
Opal I + II	312	3499	50	84	440	120	200	275	220	Yes	
Emerald I	71	765	18	24	81	32	27	60	50	Yes	
Emerald II	71	765	18	24	81	32	27	60	50	Yes	
Emerald III	71	765	18	24	81	32	27	60	50	Yes	
Emerald I + II / II + III	142	1539	24	48	179	64	63	125	110	Yes	
Emerald I + II + III	215	2315	32	66	277	96	150	225	170	Yes	
Board Rooms I, II, III	13,5	151	8	-	-	-	-	-	8	Yes	
Amber I	150	1614	46	41	117	48	54	90	70	Yes	
Amber II	45	484	16	17	48	16	24	30	20	Yes	
Topaz	116	1249	26	26	70	40	24	60	50	Yes	
Diamond	230	2548	40	90	333	128	150	225	170	Yes	
Ruby	210	2261	40	66	252	120	90	175	120	Yes	
Jade	47	506	20	-	25	16	-	50	-	Yes	
Noble (2nd floor)	45	484	-	20	48	20	-	-	-	Yes	
Summergarden	280	3014	-	-	-	-	-	200	-	Yes	
Bar The Tailor	inside	155	1668	-	-	-	-	60	-	Yes	
	terrace	104	1119	-	-	-	-	40	-		
The White Room		155	1668	upon request							
Royal Suite		120	1292	8 / 16	-	-	-	-	60	-	Yes
Presental Suite		96	1033	8	-	-	-	-	30	-	Yes

Contact for Meetings & Events

nhmeetingsales.nl@nh-hotels.com

+31 (0)85 902 23 00

nh-collection.com

Capacities are based on the maximum numbers with the use of narrow seats.